



FOLD & GLUE



FOLD & GLUE

FOLD & GLUE



FOLD & GLUE



Mo's Cookie Dough Bunny Box

 FOLD



 FOLD

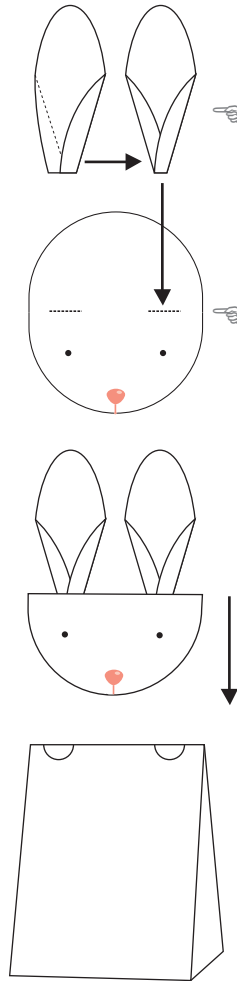
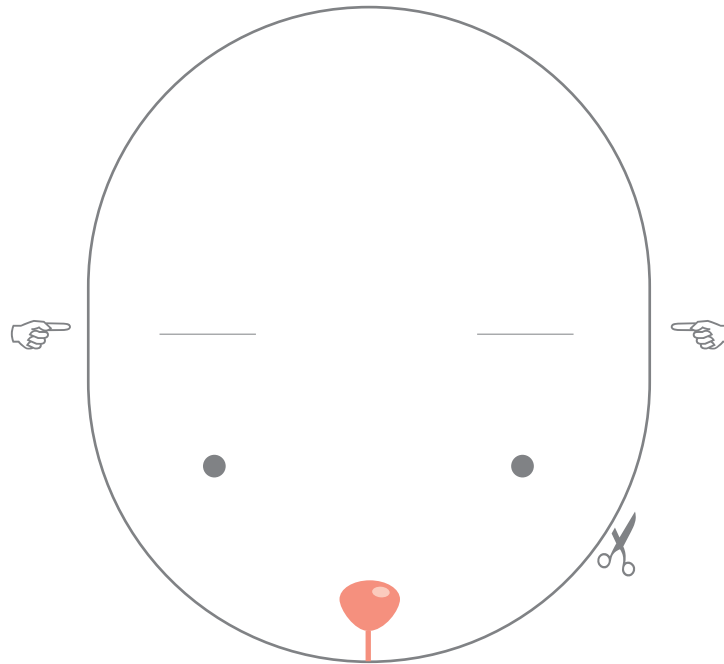
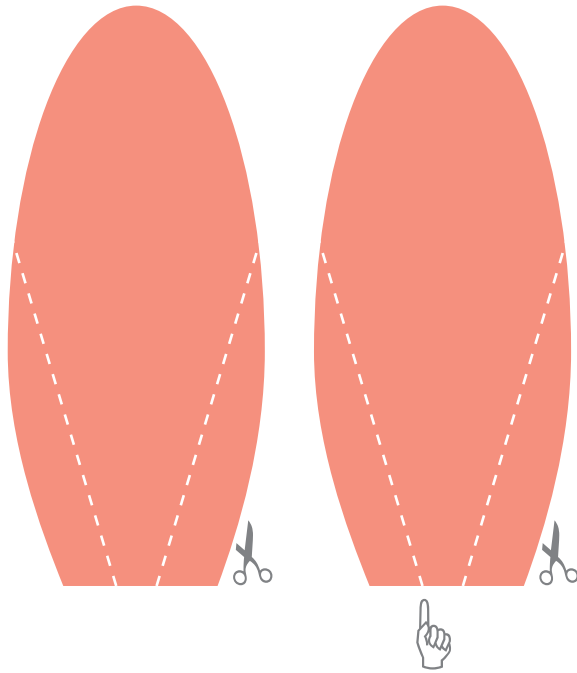

Instructions

1. Cut out ears and head
2. Fold ear inward at creases
4. Fold in half
5. Tape ears to the back of head
6. Glue the back section of the head to the back of the bag